

1 AN ORDINANCE to designate the West Central Cathedral District, located at North 38th
2 Street, Capitol Avenue to Cuming Street, as a Landmark Heritage District pursuant
3 to the Landmark Heritage Preservation Ordinance of the City of Omaha.

4 BE IT ORDAINED BY THE CITY COUNCIL OF THE CITY OF OMAHA:

5 Section 1. That the West Central-Cathedral District is located at North 38th Street,
6 Capitol Avenue to Cuming Street, which is legally described as follows:

7 Commencing at the Northeast corner of Lot 11, Block 1, Brennon Place as
8 surveyed, platted and recorded in Douglas County, Nebraska, thence East along a
9 line 33 feet South of and parallel to the center line of California Street, a
10 distance of 480 feet; thence North along a line 33 feet West of and parallel to
11 the center line of 36th Street, a distance of 1,128.3 feet; thence West along the
12 South right-of-way line of Cuming Street, a distance of 783.5 feet; thence South
13 along a line of 128 feet West of and parallel to the center line of 38th Street, a
14 distance of 384 feet; thence West along a line 33 feet South of and parallel to
15 the center line of Burt Street, a distance of 90 feet; thence South along a line
16 218 feet West of and parallel to the center line of 38th Street, a distance of 160
17 feet; thence East, a distance of 15 feet; thence South along a line 203 feet West
18 of and parallel to the center line of 38th Street, a distance of 223 feet; thence
19 West a distance of 15 feet; thence South along a line 218 feet West of and
20 parallel to the center line of 38th Street, a distance of 389 feet; thence West a
21 distance of 14 feet; thence South along a line 232 feet West of and parallel to
22 the center line of 38th Street, a distance of 135 feet; thence East a distance of
23 49 feet; thence South along a line 183 feet West of and parallel to the center line
24 of 38th Street, a distance of 195 feet; thence West a distance of 38.2 feet;
25 thence South along a line 221.2 feet West of and parallel to the center line of
26 38th Street, a distance of 410.34 feet; thence East, a distance of 29.9 feet;
27 thence South along a line 193 feet West of and parallel to the center line of 38th
28 Street, a distance of 156.12 feet; thence West, a distance of 88.25 feet; thence
29 South along a line 281.25 feet West of and parallel to the center line of 38th
30 Street, a distance of 255 feet; thence East a distance of 198.25 feet; thence
31 South along a line 83 feet West of and parallel to the center line of 38th Street,
32 a distance of 110.34 feet; thence East, a distance of 116 feet; thence South, a
33 distance of 18.2 feet; thence East along the North right-of-way line of Capitol
34 Avenue, a distance of 319 feet; thence North along a line 30 feet West of and
35 parallel to the center line of 37th Street, a distance of 241 feet; thence West, a
36 distance of 54.5 feet; thence North along a line 25 feet West of and parallel to
37 the center line of 37th Street, a distance of 59 feet; thence West, a distance of
38 128.5 feet; thence North along a line 161.5 feet East of and parallel to the
39 center line of 38th Street, a distance of 710 feet; thence East, a distance of 66.5
40 feet; thence North along a line 228 feet East of and parallel to the center line of
41 38th Street, a distance of 135 feet; thence West, a distance of 48 feet; thence
42 North along a line 180 feet East of and parallel to the center line of 38th Street,
43 a distance of 135 feet to the point of beginning.

44 Section 2. That for the reasons recited in Landmarks Heritage Preservation
45 Commission Resolution attached hereto as Exhibit I, and made a part hereof as if fully set
46 forth herein, the architectural characteristics of the West Central-Cathedral District are
47 hereby deemed significant and worthy of preservation.

48 Section 3. That the West Central-Cathedral District is hereby designated pursuant to
49 Section 24-61 of the Omaha Municipal Code, and hereby subject to all of the provisions of
50 Landmark Heritage Preservation, Ch. 24, Art. II. of the City of Omaha.

Handwritten notes:
Approved by Council
1/11/11
1/11/11

Section 4. That this Ordinance shall be in full force and take effect fifteen (15) days from and after the date of its passage.

INTRODUCED BY COUNCILMEMBER

Steve Rosenblatt

APPROVED:

Lee Boyd 1/23/81
MAYOR OF THE CITY OF OMAHA / DATE

PASSED JAN 20 1981 - As Amended 6-0

ATTEST:

Mary Gallyon Powell
CITY CLERK OF THE CITY OF OMAHA

APPROVED AS TO FORM:

Ken Berger
CITY ATTORNEY

K/8:6

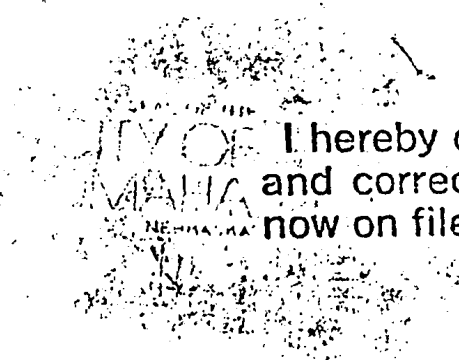

I hereby certify that the foregoing is a true and correct copy of the original document now on file in the City Clerk's office.

BY Mary Gallyon Powell
CITY CLERK

RESOLUTION - EXHIBIT I
WEST CENTRAL - CATHEDRAL LANDMARK HERITAGE DISTRICT
LANDMARKS HERITAGE PRESERVATION COMMISSION

RESOLVED BY THE LANDMARKS HERITAGE PRESERVATION COMMISSION OF THE CITY OF OMAHA:

WHEREAS, the West Central - Cathedral District developed around the Academy of the Sacred Heart, opened in 1882; and,

WHEREAS, the West Central - Cathedral District was an extension of Omaha's Second Gold Coast built after the business and commercial boom of the 1880's; and,

WHEREAS, the West Central - Cathedral District was the home of many of the City's business and professional leaders after 1900; and,

WHEREAS, structures in the West Central - Cathedral District reflect the changing architectural fashions from approximately 1900 to 1930; and,

WHEREAS, structures in the West Central - Cathedral District were designed by some of Omaha's finest architects including John and Alan McDonald, John Latenser, F. A. Henninger, and George Prinz; and,

WHEREAS, the West Central - Cathedral District's components -- the vast majority being residences -- are linked aesthetically by scale, proportion, and siting, and a variety of architectural styles, both vernacular and "high style", are manifested throughout the area, creating cohesiveness through a desirable dissimilarity as well as through similarity; and,

WHEREAS, the West Central - Cathedral District's historical landscape features aid significantly in the area's retention of its sense of time and place.

NOW, THEREFORE, BE IT RESOLVED BY THE LANDMARKS HERITAGE PRESERVATION COMMISSION OF THE CITY OF OMAHA:

THAT, the West Central - Cathedral District, North 38th Street, Capitol Avenue to Cuming Street, be designated as a Landmark Heritage District of the City of Omaha.

POOR INSTRUMENT FILED

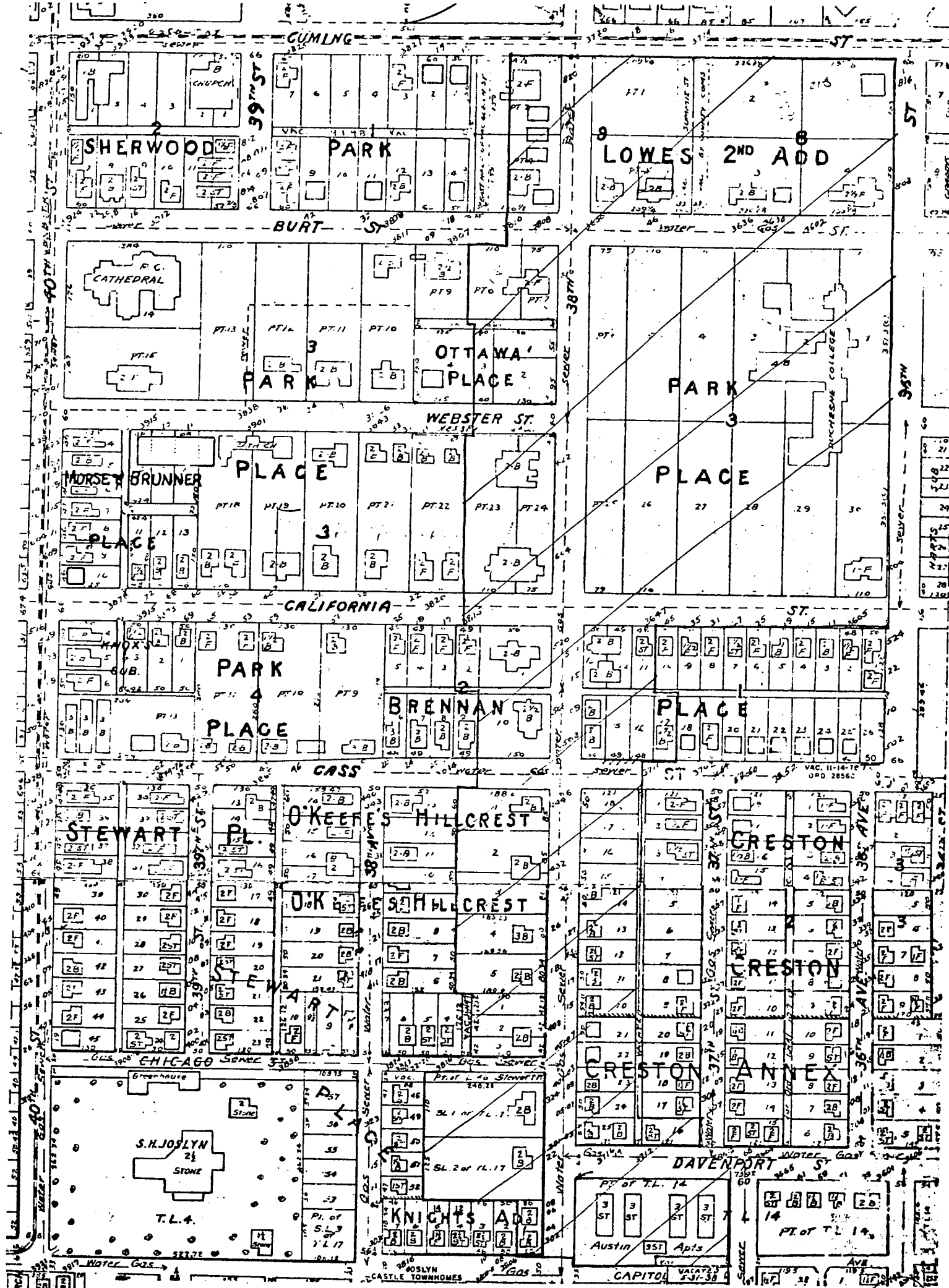

13 years

RECEIVED
1983 FEB -7 AM 11:40

CLARENCE B. ...
DOUGLAS ...

*Book 683
Page 261
of 11*

*5-0-27.50
INDEXED
COPIED*

*14-7-20758
15-0-15-13
15-9-47-2-13258 8 440.26
1-9-488-6-145 3 A-79 ATE*

- 19 CHURCH
- 18 2ST
- 17 2F
- 16 1ST
- 15 2B
- 14 2B
- 13 2B
- 12 2B
- 11 2B
- 10 2B
- 9 2B
- 8 2B
- 7 2B
- 6 2B
- 5 2B
- 4 2B
- 3 2B
- 2 2B
- 1 2B