

63-1

1055

63-1

(1917) 1319.58 surveyed.

820.60

504.82

35 35

596.25

500

9.13 AC.

31.9 AC.

153.5

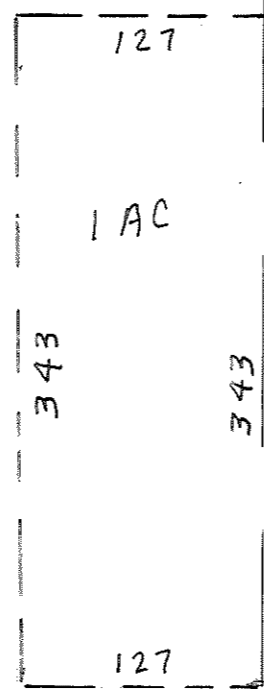

334.06

259.35

464.91

338.62

12.50

1316.53

1317.5

12.50

Surveyed 1316.53

430

454 AC

2.07 AC.

2.07 AC

430

300

108 ST - CO RD - 44

1522

33

33

300

12.15

12.50

1053

S 1/2 NE 1/4 8-16-12

944