

CORPORATE QUITCLAIM DEED

KNOW ALL MEN BY THESE PRESENTS:

LOUP RIVER PUBLIC POWER DISTRICT, a public corporation and political subdivision of the State of Nebraska, pursuant to the provisions of an agreement of Lease-Purchase (Loup - NPPS Properties) executed on November 6, 1968, by Loup River Public Power District and Nebraska Public Power District, and in consideration of the sum of One Dollar (\$1.00), received from the Grantee, and other good and valuable consideration, does hereby quitclaim and convey unto NEBRASKA PUBLIC POWER DISTRICT, a public corporation and political subdivision of the State of Nebraska, and to its successors and assigns forever, all of its right, title and interest in and to all real property of the Loup River Public Power District situated in the following counties of the State of Nebraska: Antelope, Boyd, Brown, Burt, Butler, Cedar, Cuming, Custer, Dakota, Dawson, Dodge, Fillmore, Furnas, Gage, Hall, Hamilton, Harlan, Hitchcock, Howard, Jefferson, Kearney, Knox, Lancaster, Madison, Nuckolls, Otoe, Pawnee, Phelps, Polk, Red Willow, Richardson, Saline, Sarge, Saunders, Seward, Sherman, Thayer, Valley, Wayne, ~~York~~, and York, including but not limited to the real property described on attachments A-1 through A-24, inclusive, and which are attached hereto and made a part hereof by reference, together with all appurtenances to the same belonging.

TO HAVE AND TO HOLD the premises described on attachments A-1 through A-24 hereto unto Nebraska Public Power District and to its successors and assigns; and Loup River Public Power District, for itself and its successors, does hereby agree that neither it nor any person in its name and behalf shall or will hereafter claim or demand any right or title to the said premises or any part thereof, but they and everyone of them shall by these presents be excluded and forever barred, unless some part thereof shall be hereafter reacquired by Loup River Public Power District or its successors.

IN WITNESS WHEREOF, LOUP RIVER PUBLIC POWER DISTRICT has hereunto caused its corporate seal to be affixed, and these presents to be signed by its duly authorized officers, as of November 25, 1970.

Attest:

LOUP RIVER PUBLIC POWER DISTRICT,

*[Signature]*  
Secretary

By *[Signature]*  
President

(Corporate Seal)

STATE OF NEBRASKA  
COUNTY OF PLATTE

On this 25th day of November, 1970, before me, a Notary Public in and for said county and state, personally came the above-named CLARENCE J. WITTLER, and O. N. ALLEN, President and Secretary respectively, of Loup River Public Power District, a public corporation and political subdivision of the State of Nebraska, who are personally known to me to be the identical persons whose names are affixed to the above and acknowledge the execution of said instrument to be their voluntary act and deed and the voluntary act and deed of said corporation.

WITNESS my hand and notarial seal on the date last above written.

*[Signature]*  
Notary Public

(Seal)

My Commission Expires: 5-11-71

TRACT NO. GRANTOR  
 DONIGLAS COUNTY TL NO. 1131

TRACT NO.	GRANTOR	DESCRIPTION	INSTRUMENT	EASEMENT DATE	RECORDED
142	Homer Waterman	W <sup>1/2</sup> NE <sup>1/4</sup> 1-16-9E	Easement	7-28-37	8-2-37 Book 126, MS Page 199
143	Millie D. Waterman	E <sup>1/2</sup> NE <sup>1/4</sup> 1-16-9E	Easement	7-28-37	8-2-37 Book 125, MS Page 138
144	Margretha Larsen	E <sup>1/2</sup> SW <sup>1/4</sup> 1-16-9E	Easement	7-27-37	8-2-37 Book 125, MS Page 139
145	Jesse D. Whitmore	W <sup>1/2</sup> SW <sup>1/4</sup> 4-14-10E	Easement	10-11-37	10-13-37 Book 127, MS Page 277
146	Henry D. Kirckman	E <sup>1/2</sup> SW <sup>1/4</sup> 4-14-10E	Easement	8-17-37	8-23-37 Book 126, MS Page 274
147	Guy R. Tinkham	NE <sup>1/4</sup> 7-15-10E	Easement	8-14-37	8-17-37 Book 126, MS Page 251
148	J. E. Pate et al	W <sup>1/2</sup> NW <sup>1/4</sup> 7-15-10E	Easement	7-28-37	8-2-37 Book 126, MS Page 219
149	John Zies Jr,	W <sup>1/2</sup> SW <sup>1/4</sup> 8-16-10E	Easement	7-28-37	8-2-37 Book 126, MS Page 201
150	William Powers	W <sup>1/2</sup> SW <sup>1/4</sup> 8-16-10E	Easement	7-27-37	8-2-37 Book 124, MS Page 539
151	Joseph G. Batten et al	NE <sup>1/4</sup> NW <sup>1/4</sup> 17-16-10E	Easement	5-6-37	8-6-37 Book 126, MS Page 220
151 A	Kattie Aels	NE <sup>1/4</sup> NW <sup>1/4</sup> 17-16-10E	Easement	8-4-37	8-9-37 Book 126, MS Page 221

TRAC NO.	GRANTOR	GRANTEE	INSTRUMENT	RECORD DATE	RECORD
152	WILLIE J. JINNETT	WILLIE J. JINNETT	WARRANT	7-27-37	8-2-37 BOOK 154 PAGE 458
154	JAMES ALLEN	JAMES ALLEN	WARRANT	8-11-37	8-23-37 BOOK 126, M1 PAGE 273
155	A. J. JORDON	W. W. WEAVER	EASEMENT	7-29-37	8-2-37 BOOK 124, M1 PAGE 641
156	HENRY PETERSON	HENRY PETERSON	EASEMENT	8-10-37	8-23-37 BOOK 127, M1 PAGE 39
157	ERNEST F. CARLSON	ERNEST F. CARLSON	EASEMENT	7-27-37	8-2-37 BOOK 126, M1S PAGE 200
158	DELIA OBERG	DELIA OBERG	EASEMENT	7-26-37	8-2-37 BOOK 126, M1 PAGE 202
159	FRANK ROSEB ET AL	FRANK ROSEB ET AL	EASEMENT	8-19-37	8-23-37 BOOK 127, M1 PAGE 38
160	HARCY M. SMITH	HARCY M. SMITH	EASEMENT	7-27-37	8-2-37 BOOK 124, M1 PAGE 642
161	HARCY M. SMITH	HARCY M. SMITH	EASEMENT	7-27-37	8-2-37 BOOK 125, M1 PAGE 139
162	EDWARD R. NOYES	EDWARD R. NOYES	EASEMENT	7-27-37	8-2-37 BOOK 125, M1 PAGE 140
163	HENRY M. FREEMAN	HENRY M. FREEMAN	EASEMENT	7-27-37	8-2-37 BOOK 126, M1 PAGE 203
164	U. S. OF AMERICA	U. S. OF AMERICA	EASEMENT	11-10-37	12-13-37 BOOK 158, M1

TRACT NO.	GRANTOR	TL. NO. 1158 FREEMANT-OMAHA	DESCRIPTION	INSTRUMENT	EASEMENT DATE	RECORDED
1	DOUGLAS COUNTY Stella Letchoff		S½ NW¼ 17-16N-10E	Easement	12-16-38	12-19-38 Book 134, Mls Page 114
2	Katie Zies Stiefel		SW¼ NE¼ 17-16N-10E	Easement	12-16-38	12-19-38 Book 134, Mls Page 116
3	S. C. & Ida Cowles		E½ NE¼ 17-16N-10E	Easement	12-16-38	12-19-38 Book 134, Mls Page 115
4	Alvin E. Evans		E¼ C. W. NW¼ 16-16N-10E	Easement	1-9-39	2-2-39 Book 133, Mls Page 398
5	Ray Hollingsworth et al		S½ SE¼ NW¼ & S½ S¼ NE¼ 16-16N-10E	Easement	2-15-39	3-4-39 Book 133, Mls Page 521
6	Prudential Ins. Co. of Am.		S½ NW¼ 15-16N-10E	Condemnation		
7	Clifford E. Miller et al		NE¼ 15-16N-10E	Condemnation		
8	Clifford E. Miller et al		NW¼ & Pt. NE¼ 14-16N-10E	Condemnation		
9	Adela W. Blackwell et al		Pt. NE¼ 14-16N-10E	Condemnation		
10	Margaret & Frank Finser		SW¼ NW¼ 13-16N-10E	Easement	3-11-39	3-17-39 Book 134, Mls Page 476
	Anastasia Nomos et al		SE¼ NW¼ 13-15N-10E	Easement	1-25-39	3-13-39 Book 134, Mls Page 464
	John Cooper		S½ NE¼ 13-16N-10E	Easement	11-23-40	12-17-40 Book 151, Mls Page 363
	George Ostler		S½ NW¼ 16-16N-11E	Easement	3-17-39	3-20-39 Book 133, Mls Page 589

PAGE NO.	GRANTOR	DESCRIPTION	INSTRUMENT	EASEMENT DATE	RECORDED
14	Claus & Hannah Herder	W $\frac{1}{2}$ NE $\frac{1}{4}$ 18-16N-11E	Easement	2-13-39	2-15-39 Book 133, Page 459
15	Adela Blackwell et al	E $\frac{1}{2}$ NE $\frac{1}{4}$ 18-16N-11E	Condemnation		
16	Anna Prochnow	W $\frac{1}{2}$ NW $\frac{1}{4}$ 17-16N-11E	Easement	1-25-39	2-2-39 Book 133, Page 395
17	Nettie Fackler	E $\frac{1}{2}$ NW $\frac{1}{4}$ 17-16N-11 E	Easement	1-25-39	2-2-39 Book 134, Page 297
18	Ida Kestetter	W $\frac{1}{2}$ NE $\frac{1}{4}$ 17-16N-11E	Easement	1-25-39	2-2-39 Book 134, Page 298
19	John & Kate Petersen	E $\frac{1}{2}$ NE $\frac{1}{4}$ 17-16N-11E	Easement	1-26-39	2-2-39 Book 133 Page 400
20	Emiel & Mary Wisma	S $\frac{1}{2}$ NW $\frac{1}{4}$ 16-16N-11E	Easement	1-24-39	2-2-39 Book 134, Page 294
21	Clifford E. Miller et al	NE $\frac{1}{4}$ 16-16N-11E	Condemnation		
22	Federal Land Bank of Omaha	NW $\frac{1}{4}$ 15-16N-11E	Easement	12-6-40	1-3-41 Book 151, Page 561
23	H. H. & Esther Neumeayer	W $\frac{1}{2}$ NE $\frac{1}{4}$ 15-16N-11E	Easement	4-6-39	
24	Wilhelm & Elsie Logemann	N $\frac{1}{2}$ SE $\frac{1}{4}$ 15-16N-11E	Easement	1-24-39	2-2-39 Book 133, Page 399
25	Albert & Jennie Lobe	SE $\frac{1}{4}$ SE $\frac{1}{4}$ 15-16-11E	Easement	2-13-39	2-15-39 Book 134, Page 362

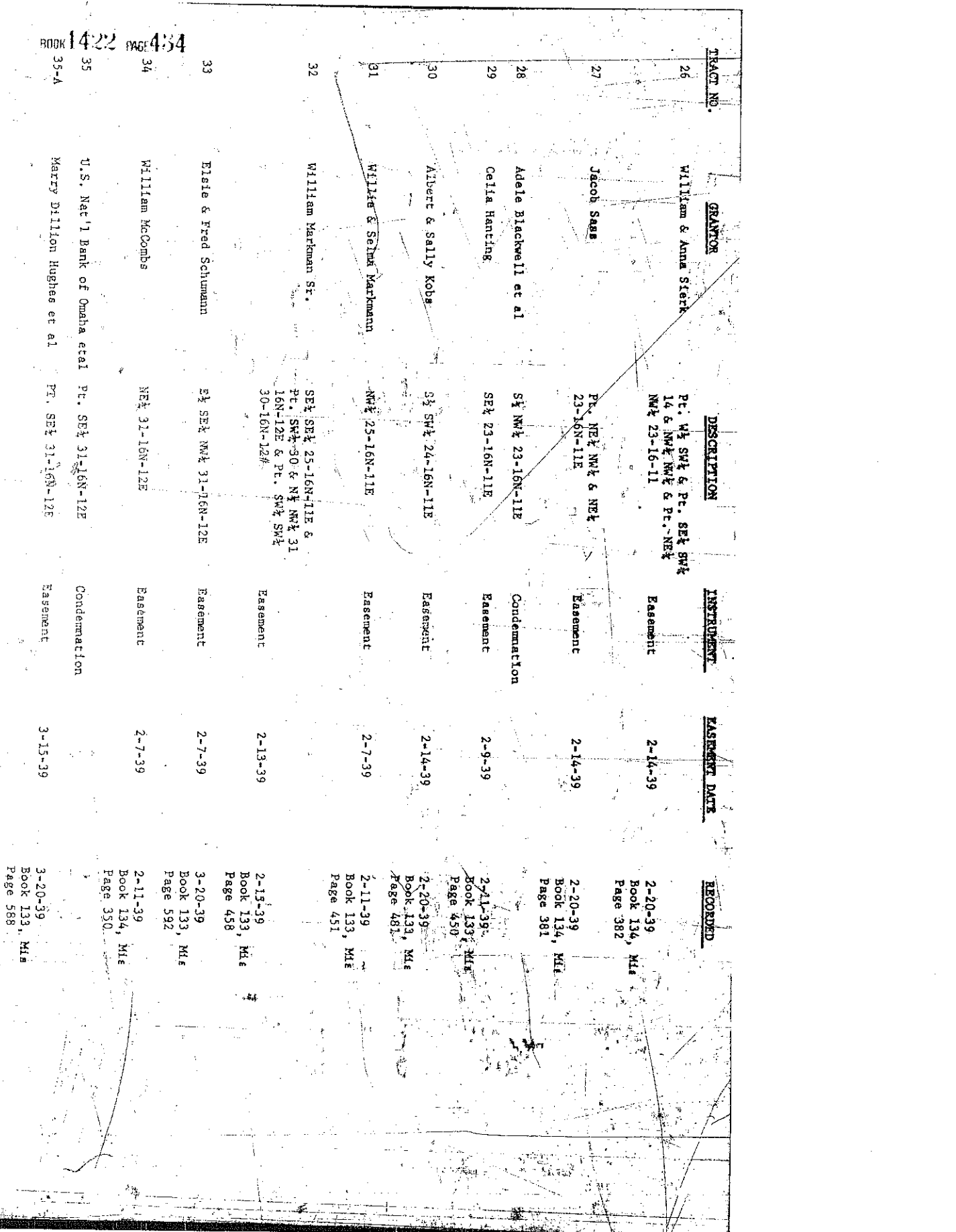

TRACT NO.	GRANTOR	DESCRIPTION	INSTRUMENT	EASEMENT DATE	RECORDED
26	William & Anna Stern	Pt. NW SW & Pt. SE SW 14 & NW NW & Pt. NE NW 23-16-11	Easement	2-14-39	2-20-39 Book 134, ME Page 382
27	Jacob Saxe	Pt. NE NW & NE 23-16N-11E	Easement	2-14-39	2-20-39 Book 134, ME Page 381
28	Adelle Blackwell et al	SW NW 23-16N-11E	Condemnation		
29	Celia Hanting	SE 23-16N-11E	Easement	2-9-39	2-21-39 Book 133, ME Page 450
30	Albert & Sally Koby	SW SW 24-16N-11E	Easement	2-14-39	2-20-39 Book 133, ME Page 481
31	Walter & Selma Markmann	NW 25-16N-11E	Easement	2-7-39	2-11-39 Book 133, ME Page 451
32	William Markman Sr.	SE SW 25-16N-11E & Pt. SW 30 & NW NW 31 16N-12E & Pt. SW SW 30-16N-12W	Easement	2-13-39	2-13-39 Book 133, ME Page 458
33	Elsie & Fred Schumann	SW SW NW 31-16N-12E	Easement	2-7-39	3-20-39 Book 133, ME Page 592
34	William McCombs	NE 31-16N-12E	Easement	2-7-39	2-11-39 Book 134, ME Page 350
35	U.S. Nat'l Bank of Omaha et al	Pt. SE 31-16N-12E	Condemnation		
35-A	Mary Dillion Hughes et al	Pt. SE 31-16N-12E	Easement	3-15-39	3-20-39 Book 133, ME Page 588

BOOK 1422 PAGE 434

BOOK 1422 PAGE 435

TRACT NO.	GRANTOR	DESCRIPTION	INSTRUMENT	EASEMENT DATE	RECORDED
36	Fred Bauernmeister	Pt. NW 5-15N-12E	Easement	3-11-39	3-13-39 Book 135, M18 Page 64
37	Dial Construction Co.	W 1/2 NE 5-15N-12E	Release of Easement	8-6-68	9-3-68 Book 467, M18 Page 705
	Hildur Bower	W 1/2 NE 5-15N-12E	Easement	3-2-39	3-6-39 Book 134, M18 Page 446
38	Adele Blackwell et al	NW 1/2 SE 5-15N-12E	Condemnation		
39	Ivan & Bessie Carpenter	Pt. W 1/2 NE 8-15-12 & Pt. SE 5-15N-12 E	Easement	3-8-39	3-13-39 Book 133, M18 Page 555
40	Helen & William Bucher	Pt. W 1/2 NE 8-15N-12E	Easement	3-2-39	3-6-39 Book 133, M18 Page 529
41	J. W. Elwood et al	W 1/2 NE 8 & W 1/2 SE 8-15N-12E	Condemnation		
42	Charles & Marie McNamara	S 1/2 NE 8 & NW 1/2 NE 17-15N-12E	Easement	2-17-39	3-4-39 Book 133, M18 Page 519
43	Agathe Peetz	E 1/2 SE 8 & Pt. W 1/2 SE 15-15N-12E	Easement	3-11-39	3-13-39 Book 133, M18 Page 554
44	Mads & Cristine Thomsen	Pt. N 1/2 SE 17-15N-12E & Pt. S 1/2 SE 17-15N-12E	Easement	3-10-39	3-13-39 Book 135, M18 Page 65
45	Richard & Anna Horn	Pt. W 1/2 SE 17-15-12	Easement	3-15-39	3-20-39 Book 134, M18 Page 491

TRACT NO.	GRANTOR	DESCRIPTION	INSTRUMENT	EASEMENT DATE	RECORDED
46	Mayne Dagerman et al	N $\frac{1}{2}$ NE $\frac{1}{4}$ 20-15N-12E	Easement	3-16-39	4-19-39 Book 136, Mls Page 61
48	Emma & Chris Kuehl	N $\frac{1}{2}$ NW $\frac{1}{4}$ SE $\frac{1}{4}$ & Pt. N $\frac{1}{2}$ NE $\frac{1}{4}$ SE $\frac{1}{4}$ 20 & S $\frac{1}{2}$ NE $\frac{1}{4}$ SE $\frac{1}{4}$ & N $\frac{1}{2}$ S $\frac{1}{2}$ NW $\frac{1}{4}$ SE $\frac{1}{4}$ 20-15N-12E & S $\frac{1}{2}$ S $\frac{1}{2}$ NW $\frac{1}{4}$ SE $\frac{1}{4}$ 20-15N-12E	Easement	3-2-39	3-6-39 Book 133, Mls Page 530
49	George A. Rohwer	SW $\frac{1}{4}$ SE $\frac{1}{4}$ & Pt. SE $\frac{1}{4}$ SE $\frac{1}{4}$ 20-15N-12E	Condemnation		
47	John & Margaretha Lamprecht et al	SW $\frac{1}{4}$ NE $\frac{1}{4}$ 20-15N-12E	Easement	3-8-39	3-20-39 Book 133, Mls Page 589
50	Henry & Emma Rohwer	E $\frac{1}{2}$ NE $\frac{1}{4}$ 29-15N-12E	Easement	3-14-39	3-17-39 Book 134, Mls Page 474
52	Neil Langdon	NW $\frac{1}{4}$ SE $\frac{1}{4}$ & Pt. NE $\frac{1}{4}$ SE $\frac{1}{4}$ 29-15-12E	Condemnation		
53	Henry Goech	SW $\frac{1}{4}$ SE $\frac{1}{4}$ & S $\frac{1}{2}$ NW $\frac{1}{4}$ SE $\frac{1}{4}$ 29-15N-12E	Easement	3-14-39	3-17-39 Book 134, Mls Page 475
54	Clifford Miller, et al	NE $\frac{1}{4}$ 20-15N-12E	Condemnation		
55	Clifford Miller, et al	SE $\frac{1}{4}$ 32-14N-12E	Condemnation		
56	Clifford Miller et al	NW $\frac{1}{4}$ NE $\frac{1}{4}$ 5-14N-12E	Condemnation		
57	Leroy & Irene Gans	S $\frac{1}{2}$ NE $\frac{1}{4}$ 5-15N-12E	Easement	3-2-39	3-6-39 Book 134, Mls Page 446
58	William & Lena Blum	SE $\frac{1}{4}$ 5-14N-12E	Easement	3-10-39	3-13-39 Book 133, Mls Page 556



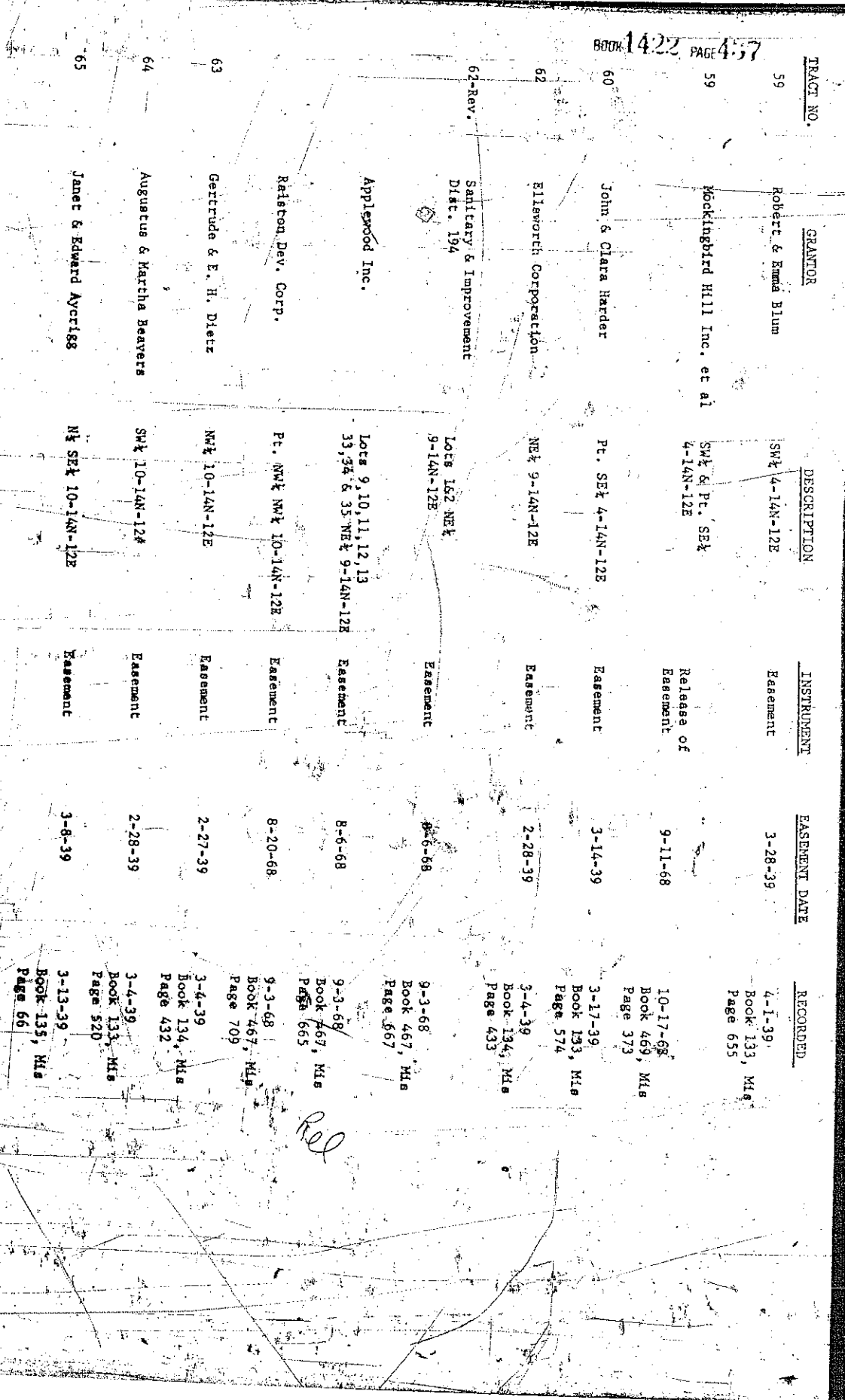

TRACT NO. GRANTOR DESCRIPTION INSTRUMENT EASEMENT DATE RECORDED

59 Robert & Emma Blum SW 1/4-14N-12E Easement 3-28-39 4-1-39, Book 133, Mls Page 655

59 Mockingbird Hill Inc, et al SW 1/4 & Pt. SE 1/4 4-14N-12E Release of Easement 9-11-68 10-17-68, Book 469, Mls Page 373

60 John & Clara Harder Pt. SE 1/4 4-14N-12E Easement 3-14-39 3-17-39, Book 133, Mls Page 574

62 Ellsworth Corporation NE 1/4 9-14N-12E Easement 2-28-39 3-4-39, Book 134, Mls Page 433

62-Rev. Sanitary & Improvement Dist. 194 Lots 1&2 NE 1/4 9-14N-12E Easement 8-6-68 9-3-68, Book 467, Mls Page 567

Appleswood Inc. Lots 9, 10, 11, 12, 13, 33, 34 & 35 NE 1/4 9-14N-12E Easement 8-6-68 9-3-68, Book 467, Mls Page 665

Ralston Dev. Corp. Pt. NW 1/4 NW 1/4 10-14N-12E Easement 8-20-68 9-3-68, Book 467, Mls Page 709

63 Gertrude & E. H. Dietz NW 1/4 10-14N-12E Easement 2-27-39 3-4-39, Book 134, Mls Page 432

64 Augustus & Martha Beavers SW 1/4 10-14N-12E Easement 2-28-39 3-4-39, Book 133, Mls Page 520

65 Janet & Edward Aycriss NE 1/4 SE 1/4 10-14N-12E Easement 3-8-39 3-13-39, Book 135, Mls Page 66

Rel

TRACT NO.	GRANTOR	DESCRIPTION	INSTRUMENT	EASEMENT DATE	RECORDED
65	Janet & Edward Aycriss	N $\frac{1}{2}$ SE $\frac{1}{4}$ 10-14N-12E	Release of Easement	4-10-68	
67	Louise & Joseph Vomacka	SE $\frac{1}{4}$ SE $\frac{1}{4}$ 10-14N-12E	Easement	3-14-39	3-17-39 Book 133, M18 Page 573
67	Fairview Heights Inc.	Pl. SE $\frac{1}{4}$ SE $\frac{1}{4}$ 10-14-12E	Easement	2-16-62	4-18-62 Book 379, M18 Page 213
68*	Arthur Larson	SW $\frac{1}{4}$ SW $\frac{1}{4}$ 11-14N-12E	Easement	3-14-39	3-17-39 Book 135, M18 Page 86

PL. NO. 1152

TRACT NO.

GRANTOR  
DOUGLAS COUNTY

DESCRIPTION

INSTRUMENT

EASEMENT DATE

RECORDED

71-B & 73

H. B. Cowles

NE 1/4 NW 1/4 6-14N-10E & SE 1/4 & E 1/4 SW 1/4 36-15N-9E & NW 1/4 6-14-10E

Condemnation

5-10-45

5-26-45  
Book 199, Mls  
Page 449

S. C. & Ida Cowles

Pt. SW 1/4 SW 1/4 31-15N-10E

Easement

4-17-42

5-26-45  
Book 199, Mls  
Page 450

72-B

John & Verna Zimmerman

SW 1/4 31-15N-10E

Easement

5-11-45

5-26-45  
Book 199, Mls  
Page 452

Louise Foster

W 1/2 SW 1/4 5-14N-10E

Easement

4-17-42

5-26-45  
Book 199, Mls  
Page 453

74-B

J. C. Robinson Real Est. Co.

E 1/2 SW 1/4 5-14N-10E

Easement

9-27-42

12-23-43  
Book 181, Mls  
Page 555

J. L. & Floy Clark

W 1/2 SE 1/4 5-14N-10E

Easement

3-27-42

12-23-43  
Book 181, Mls  
Page 554

J. L. & Floy Clark

W 1/2 NE 1/4 8-14N-10E

Easement

3-27-42

5-26-45  
Book 199, Mls  
Page 454

Ora & John Dyer

E 1/2 NE 1/4 8-14N-10E

Easement

3-27-42

5-26-45  
Book 199, Mls  
Page 455

John E. Dyer

NW 1/4 NW 1/4 & S 1/2 NW 1/4 & SW 1/4 9-14N-10E

Easement

4-3-42

9-27-43  
Book 178, Mls  
Page 573

Mary Kossilla

SW 1/4 9-14N-10E

Easement

4-2-42

12-23-43  
Book 181, Mls  
Page 553

76-D

Charles & Annie Oberc

S 1/2 SE 1/4 9-14N-10E

Easement

TRACT NO.	GRANTOR	DESCRIPTION	INSTRUMENT	EASEMENT DATE	RECORDED
76-2	Annie & Charles Ober	S 1/2 SE 1/4 (pt) 9-1AN-10E	Easement	4-2-42	12-23-43 Book 181, M18 Page 556
	DOUGLAS COUNTY				
	Prairie Hills Corporation	W 1/2 NE 1/4 32-15N-12E	Easement	1-26-59	3-9-59 Book 389, M1 Page 671
	August B. Olson	SE 1/4 29-15N-12E	Easement	5-17-60	
	Henry & Barbara Gosch	S 1/4 SE 1/4 & S 1/4 S 1/4 NW 1/4 SE 1/4 29-15N-12E	Easement	2-17-59	3-9-59 Book 389, M1 Page 661
	Madeline & Eugene Jacobson	Lots 95, 96, 97, 98, 99 135 & 136 & Lots 243 Blair 2nd add.	Easement	3-2-59	3-9-59 Book 339, M1 Page 665
	Cecil Miller	Pt. S 1/2 SE 1/4 20-15N-12E	Revision of Easement	3-13-59	

37  
 FILED IN NUMERICAL INDEX AND RECORDED IN THE REGISTER OF DEEDS OFFICE IN DOUGLAS COUNTY, NEBRASKA  
 24 DAY OF Dec. 1970 AT 1:06 P.M. C. HAROLD OSTLER, REGISTER OF DEEDS

53 25