

37-613

BEFORE THE COUNTY JUDGE OF SARPY COUNTY, NEBRASKA

THE STATE OF NEBRASKA  
DEPARTMENT OF ROADS

Condemner

vs.

RETURN OF APPRAISERS

ROBERT C. HASTINGS, Owner; ADA  
HASTINGS, wife of ROBERT C.  
HASTINGS;

JOHN O. COCKERILL, Owner; CARRIE  
COCKERILL, wife of JOHN O.  
COCKERILL;

FRANK A. PFLUG, Owner; ETTA F.  
PFLUG, wife of FRANK A. PFLUG;

RALPH HICKEY, a single man, GUY  
G. HICKEY, a single man, and  
HOWARD H. HICKEY, Tenants in  
Common; PAULA HICKEY, wife of  
HOWARD H. HICKEY;

WILLIAM MORRISON, Owner; LOLA  
MORRISON, wife of WILLIAM MORRISON;

FILED FOR RECORD IN SARPY COUNTY NEBR. *June 6 1963* AT 11 O'CLOCK A.M.

AND RECORDED IN BOOK *31* OF *Rec* PAGE *613* (*Hoise Banker*) REGISTER OF DEEDS

Condemnees

TO HONORABLE JOS. E. STRAWN, COUNTY JUDGE OF SARPY COUNTY, NEBR.

We, the undersigned appraisers, do hereby certify that under and by virtue of an "Appointment of Appraisers" duly served upon us by *Richard A. Fittled*, Sheriff or ~~Deputy Sheriff~~ of Sarpy County, Nebraska, on the *19* day of *April*, 1963, and after having taken and filed the "Oath of Appraisers" that we did carefully inspect and view the property described herein, sought to be appropriated by the State of Nebraska, Department of Roads, and also other property of the condemnees alleged damaged thereby and did hear all parties interested therein in reference to the amount of damages sustained while we were so inspecting and viewing the property herein described and thereafter did assess the damages that the condemnees have sustained or will sustain by such appropriation of the property herein described for State highway purposes and also damage to such other property of the condemnees as in our opinion was damaged by the appropriation of the property herein described:

31-614

C O N D E M N A T I O N

Land Owners: Robert C. Hastings and Ada Hastings, husband and wife.

Project: 1-80-9 (94) AFE: R-172b Sarpy County, Nebraska

Permanent easement to a tract of land for the control of outdoor advertising as illustrated on the attached plat and being more particularly described as all that part of the Northeast Quarter of Section 18, Township 14 North, Range 12 East of the 6th P.M., Sarpy County, Nebraska, lying northerly from and within 660 feet of the Interstate Highway Right of Way Controlled Access line as measured at right angles to the centerline of said Interstate Highway, and being in accordance with the provisions of Section 84-907, R.R.S. 1943; approved and filed on June 15, 1961.

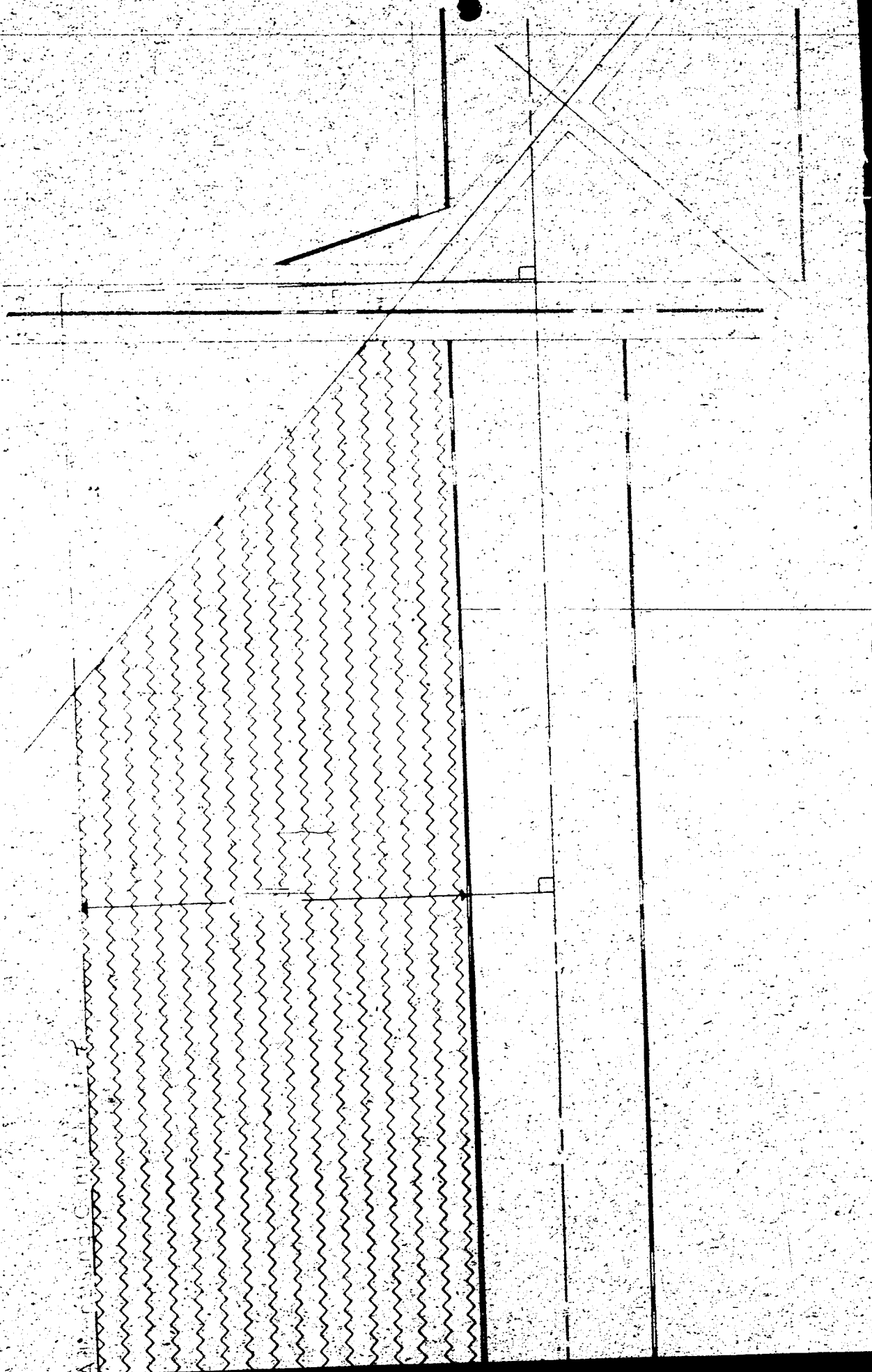

31-615

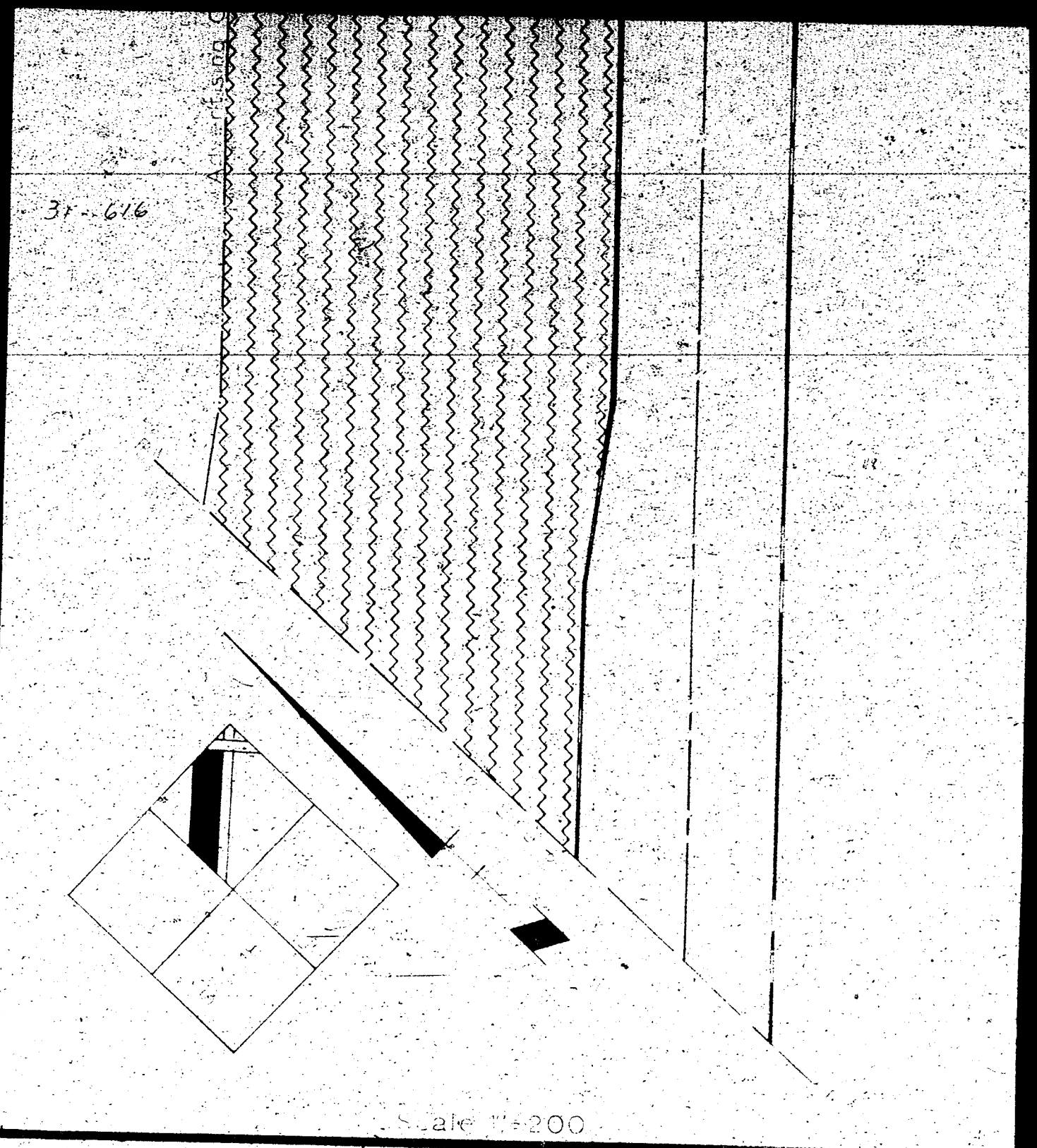

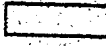
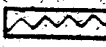

Scale 1"=200'

Advertising Control  
 to be acquired for Interstate Highway purposes  
 Project: I-80-9(94) Sarpy County A.F.E.R. 172B  
 Tract: 278  
 Holder of Record: Robert C. Hastings  
 Location: NE 1/4, Sec 18-T14N-R12E  
 all north of Interstate ROW Line

-  Old ROW
-  Advertising Easement
-  Controlled Access

drawn by *AAH*  
 checked by *CPB*  
 verified by *...*

31-618

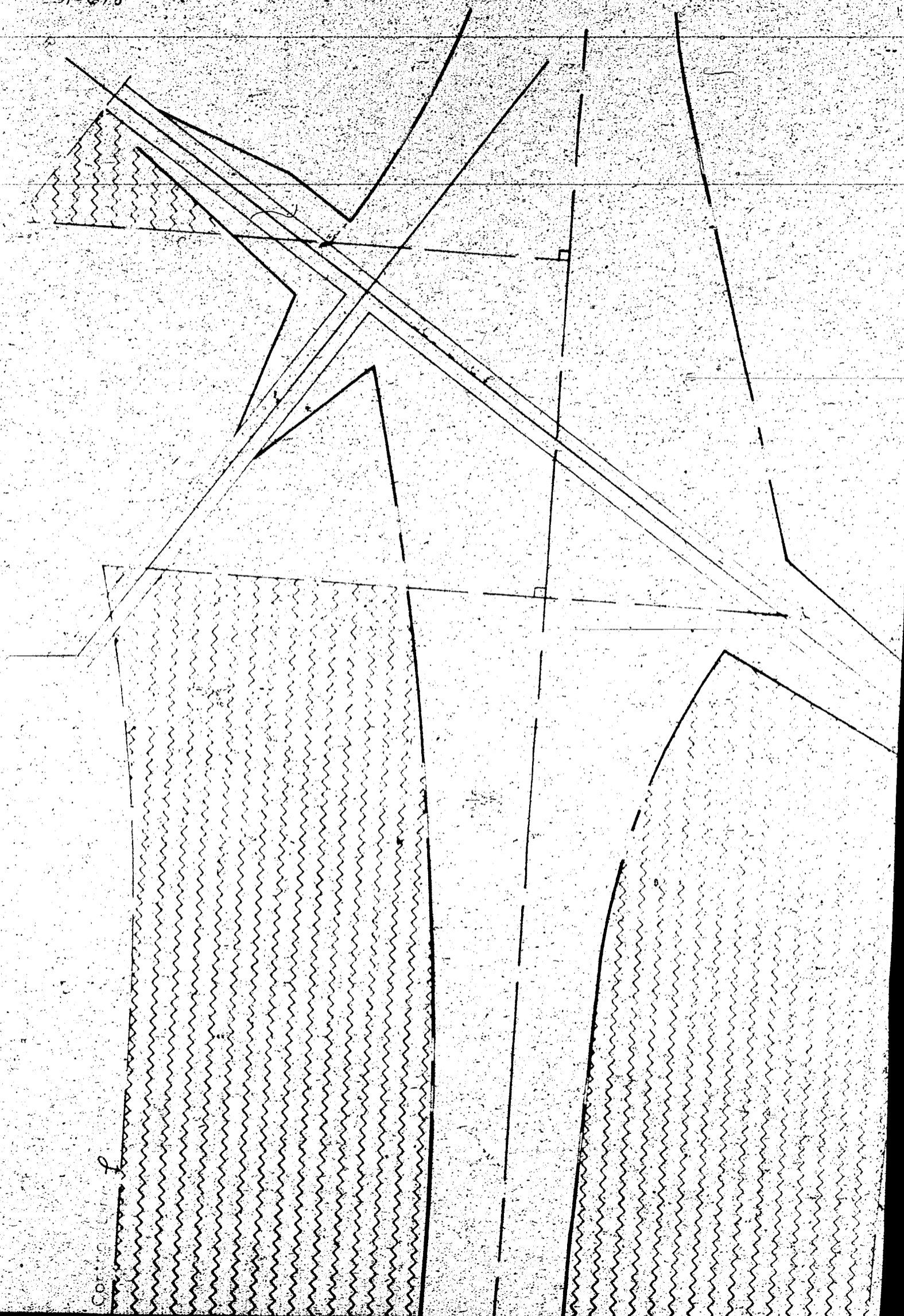

Cor. 1/2" L

37-617



to be acquired for Interstate Highway Project  
 I-80-9(94) Sarpy County A.P.E.R.  
 Contract 165  
 of Record John O. Cokerill  
 on SE 1/4 and E 1/2 of NE 1/4 in Sec 14-T13N-R 05

R.O.W.  
 Advertising Easement  
 Controlled Access

Drawn: NKS  
 Checked: WCF  
 Written: WDE  
 Checked: CES

CONDEMNATION

Land Owners: Frank A. Pflug and Etta E. Pflug, husband and wife.

Project: I-80-9 (94) AFE: R-172b Sarpy County, Nebraska

Permanent easement to a tract of land for the control of outdoor advertising as illustrated on the attached plat and being more particularly described as all that part of the Southwest Quarter of Section 26, Township 14 North, Range 11 East of the 6th P.M., Sarpy County, Nebraska, lying within 660 feet of the Interstate Highway Right of Way Controlled Access lines as measured at right angles to the centerline of said Interstate Highway, and being in accordance with the provisions of Section 84-907, R.R.S. 1943; approved and filed on June 15, 1961.

37-631

37

